

# 1A

## STAND-ALONE KITCHEN 78 SQM (NET)

Perfect for city dwellers, young professionals or the long-term expat, this comfy one-bedroom has two balconies, and a good-sized living room with a separate kitchen, large enough to cook at home.

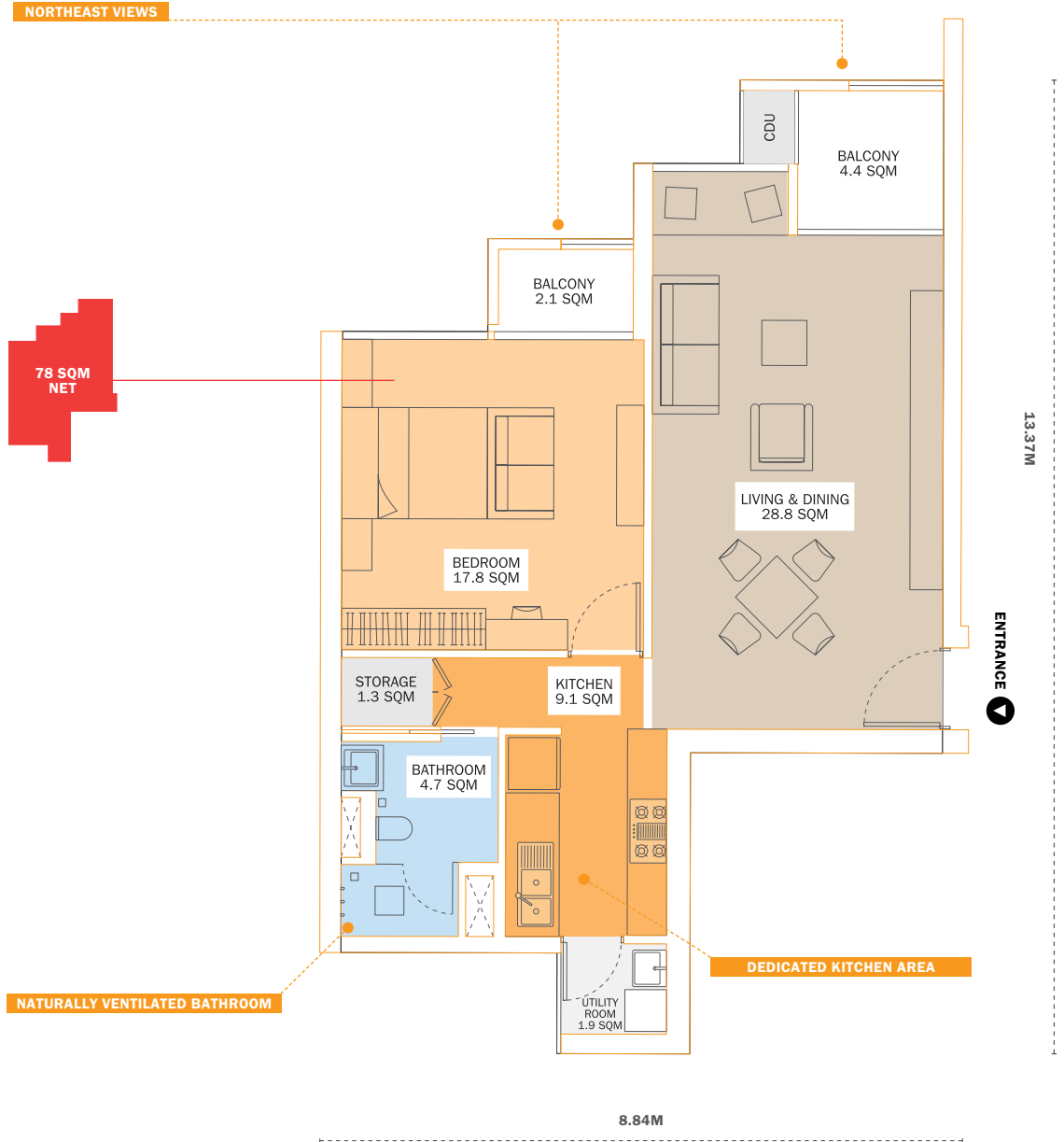

**Net SQM Calculation** Net calculation is based on the perimeter red line as indicated.  
**Room Areas** Measurements for rooms are approximate only and calculated based on expected usable space, excluding walls and extrusions. Room spaces will total less than the total NET space. Please refer to dimensions or drawings provided for the unit with the SPA.

**Variance** These drawings represent conceptual layout before final engineering stage and are subject to change based on regulatory or technical requirements.



# 1A

## STAND-ALONE KITCHEN 78 SQM (NET)

1A homes face northeast, allowing for ample sunlight while also receiving shade from Odom Tower.

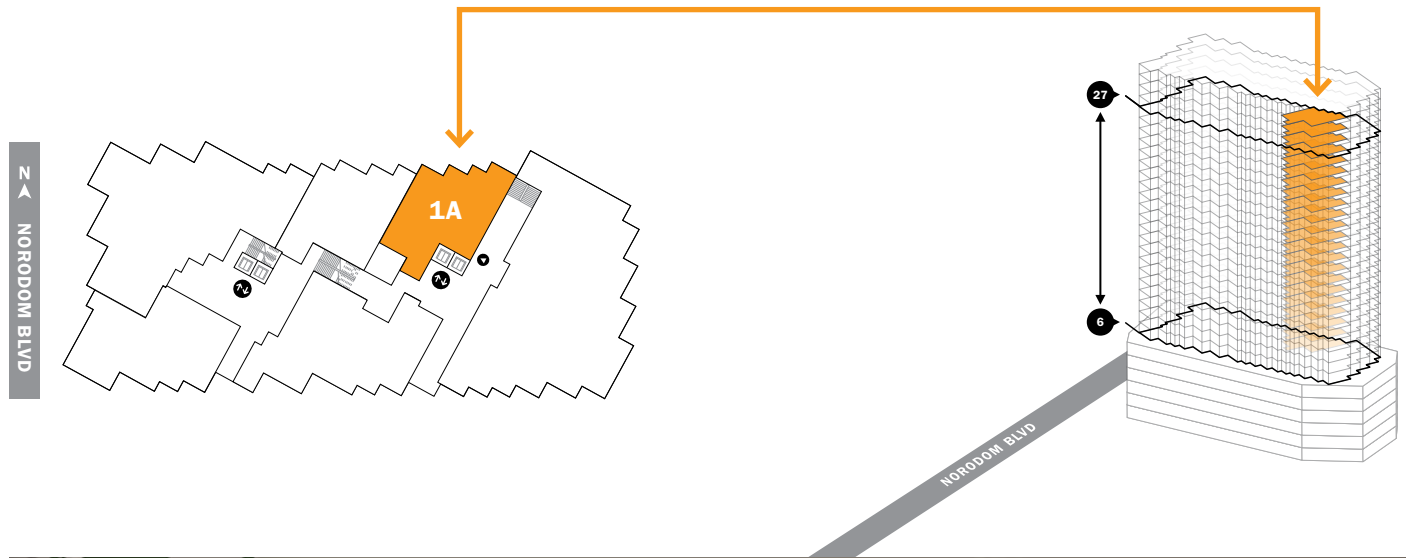

## AMENITIES

### EQUIPPED KITCHEN\*

- 4-plate electric stove
- Electric hood
- Oven
- High-quality sink

\*Refrigerator not included

### DESIGN-FOCUSED BATHROOMS

- Glass-doored shower
- Sink
- Vanity
- Toilet
- Naturally ventilated bathroom
- 1 shower, 1 toilet, 1 basin

### COMFORTS THROUGHOUT THE HOME

- Living room balcony
- En suite bedroom balcony
- Large bay window in the living area
- Energy-efficient AC units in living areas and bedrooms
- Parquet flooring in bedrooms, Living and Dining areas
- Beautifully tiled floors in Kitchen areas
- Ceiling fans



NORTHEAST FACING VIEW FROM LIVING ROOM, UNIT 1B